

Geländerteile aus VA / Rohrverbinder + Zubehör

VA railing components / tube connectors + accessories



BEST by
QUALITY **DM**

Rohrverbinder I tube connector

90° rund, Korn 320
90° round, finish 320

Art- Nr. art. no.	Material material	Rohr ø tube
10 30 00 00	A2	33,7 x 2,0
10 30 01 00	A2	42,4 x 2,0
10 40 35 00	A2	48,3 x 2,0
10 55 24 00	A4	33,7 x 2,0
10 55 25 00	A4	42,4 x 2,0



BEST by
QUALITY **DM**

Rohrverbinder I tube connector

90° eckig, Korn 320
90° square, finish 320

Art- Nr. art. no.	Material material	Rohr ø tube
10 30 02 00	A2	33,7 x 2,0
10 30 03 00	A2	42,4 x 2,0
10 40 36 00	A2	48,3 x 2,0
10 55 26 00	A4	33,7 x 2,0
10 55 27 00	A4	42,4 x 2,0



BEST by
QUALITY **DM**

Endbogen I end elbow

flach, Korn 320
flat, finish 320

Art- Nr. art. no.	Material material	Rohr ø tube
10 30 97 00	A2	42,4 x 2,0



BEST by
QUALITY **DM**

Rohrverbinder I tube connector

135°, Korn 320
135°, finish 320

Art- Nr. art. no.	Material material	Rohr ø tube
10 30 75 00	A2	33,7 x 2,0
10 30 76 00	A2	42,4 x 2,0
10 40 37 00	A2	48,3 x 2,0
10 55 30 00	A4	33,7 x 2,0
10 55 31 00	A4	42,4 x 2,0



Rohrverbinder I tube connector

stufenlos verdrehabar, Korn 320
infinitely adjustable, finish 320

Art- Nr. art. no.	Material material	Rohr ø tube
10 30 18 00	A4	33,7 x 2,0
10 30 19 00	A4	42,4 x 2,0



BEST by
QUALITY **DM**

Rohrverbinder I tube connector

180°, Korn 320
180°, finish 320

Art- Nr. art. no.	Material material	Rohr ø tube
10 30 78 00	A2	33,7 x 2,0
10 30 79 00	A2	42,4 x 2,0
10 55 34 00	A4	33,7 x 2,0
10 55 35 00	A4	42,4 x 2,0

Geländerteile aus VA / Rohrverbinder + Zubehör

VA railing components / tube connectors + accessories



BEST by
QUALITY **DM**

Rohrverbinder | tube connector

T-Stück, Korn 320
T-connector, finish 320

Art- Nr. art. no.	Material material	Rohr ø tube
10 30 74 00	A2	33,7 x 2,0
10 30 04 00	A2	42,4 x 2,0
10 55 28 00	A4	33,7 x 2,0
10 55 29 00	A4	42,4 x 2,0



BEST by
QUALITY **DM**

Rohrverbinder | tube connector

Eckverbinder 3-fach, Korn 320
corner connector, finish 320

Art- Nr. art. no.	Material material	Rohr ø tube
10 30 77 00	A2	33,7 x 2,0
10 30 05 00	A2	42,4 x 2,0
10 55 32 00	A4	33,7 x 2,0
10 55 33 00	A4	42,4 x 2,0



BEST by
QUALITY **DM**

Rohrverbinder | tube connector

mit Gelenk, Korn 320
with joint, finish 320

Art- Nr. art. no.	Material material	Rohr ø tube
10 30 80 00	A2	33,7 x 2,0
10 30 06 00	A2	42,4 x 2,0
10 55 36 00	A4	33,7 x 2,0
10 55 37 00	A4	42,4 x 2,0



Sprezhülse | expansion sleeve

mit Klemmbacken, Korn 320
with clamping sleeve, finish 320

Art- Nr. art. no.	Material material	Rohr ø tube
10 30 09 00	A2	33,7 x 2,0
10 30 10 00	A2	42,4 x 2,0
10 30 11 00	A2	42,4 x 2,6



Verbindungshülse | connector sleeve

geschlitzt, roh
slotted, raw

Art- Nr. art. no.	Material material	Rohr ø tube
10 30 16 00	A2	33,7
10 30 17 00	A2	42,4



Rohrabschlusskugel | ball end cap

Korn 320
finish 320

Art- Nr. art. no.	Material material	↔ Aufnahme adapter
10 60 14 00	A2	45 33,7
10 60 09 00	A2	55 42,4

Geländerteile aus VA / Rohrverbinder + Zubehör

VA railing components / tube connectors + accessories



BEST by
QUALITY **DM**

Flanschplatte | flange plate

Korn 320 | finish 320

Art- Nr. art. no.	Material material	Rohr ø tube	
10 30 82 00	A2	33,7	ø 85 x 30
10 30 83 00	A2	42,4	ø 95 x 30



BEST by
QUALITY **DM**

Anschlussstück | tube adapter

90°, Korn 320 | 90°, finish 320

Art- Nr. art. no.	Material material	Rohr ø tube	Aufnahme adapter
10 30 81 00	A2	33,7 x 2,0	33,7
10 30 56 00	A2	33,7 x 2,0	42,4
10 30 15 00	A2	42,4 x 2,0	42,4





Anschweißbogen I welding elbow

90°, Korn 240 (nach dem Biegen nicht nachgeschliffen)
90°, finish 240 (after bending surface not brushed)

Art- Nr. art. no.	Material material	Rohr ø tube	rm*
10 90 12 00	A2	33,7 x 2,0	70
10 90 13 00	A2	42,4 x 2,0	100

* mittlerer Biegeradius I middle bending radius



Anschweißbogen I welding elbow

180°, Korn 240 (nach dem Biegen nicht nachgeschliffen)
180°, finish 240 (after bending surface not brushed)

Art- Nr. art. no.	Material material	Rohr ø tube	rm*
10 90 08 00	A2	33,7 x 2,0	70
10 90 10 00	A2	42,4 x 2,0	85
10 90 11 00	A2	42,4 x 2,0	100

* mittlerer Biegeradius I middle bending radius



Wandanschluss I wall mounting

roh I raw

Art- Nr. art. no.	Material material	Rohr ø tube	
10 31 31 00	A4	42,4 x 2,0	38,2



Anschweißbogen I welding elbow

Korn 320 I finish 320

Art- Nr. art. no.	Material material	Rohr ø tube
10 30 22 00	A2	33,7 x 2,0
10 30 23 00	A2	42,4 x 2,0
10 20 83 48 A2	A2	48,3 x 2,0

BEST by
QUALITY **DM**

Geländerteile aus VA / Rohrverbinder + Zubehör

VA railing components / tube connectors + accessories



Holzhandlauf I wooden handrail

Buche beschichtet, DD Lack
beech treated, DD lacquer

Art- Nr. art. no.	ø	
10 30 31 00	42,4	2000
10 30 32 00	42,4	3000

Holzhandlauf I wooden handrail

Eiche beschichtet, DD Lack
oak treated, DD lacquer

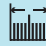
Art- Nr. art. no.	ø	
10 30 33 00	42,4	2000
10 30 34 00	42,4	3000



Adapter I adapter

für Endkappen
for end caps

Art- Nr. art. no.	Material material	ø
10 30 28 00	POM	38,4

Endkappe I end cap

Korn 320
finish 320

Art- Nr. art. no.	Material material	ø
10 30 29 00	A2	42,4

Endkappe I end cap

Adapter für Verbinder, Korn 320
adapter for connectors, finish 320

Art- Nr. art. no.	Material material	ø
10 30 30 00	A2	42,4

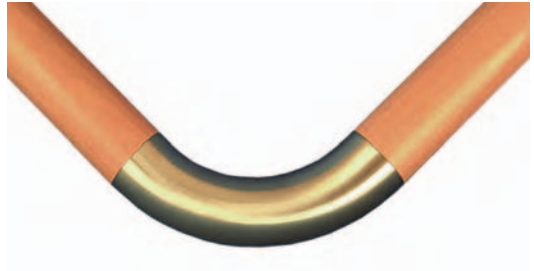
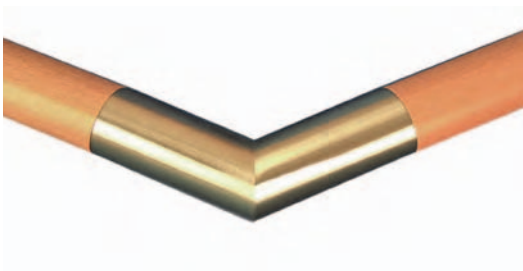
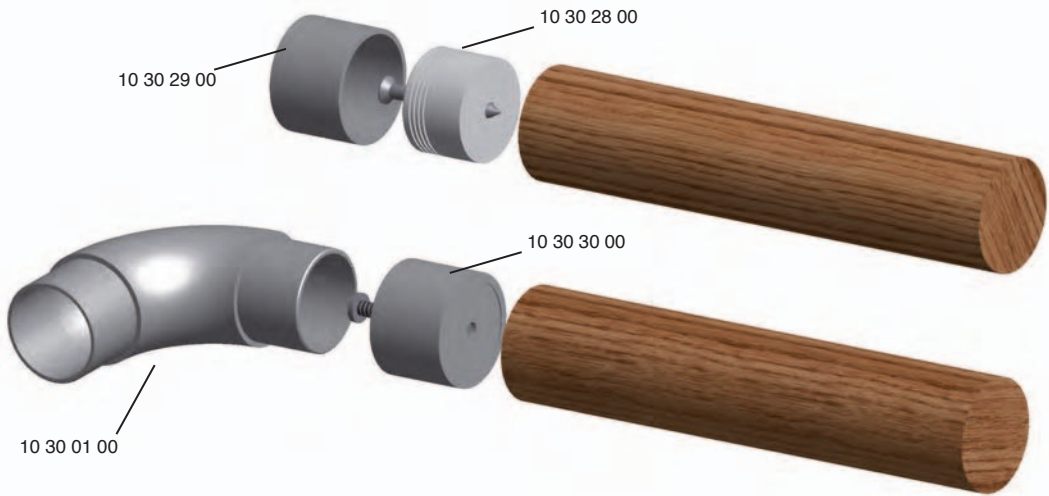

Info

Auch mit selbst angefertigten Rohrbögen sind schöne Kombinationen von Edelstahl und Holz jetzt möglich
It now beautiful combinations of stainless steel and wood are possible